

BIG FISH

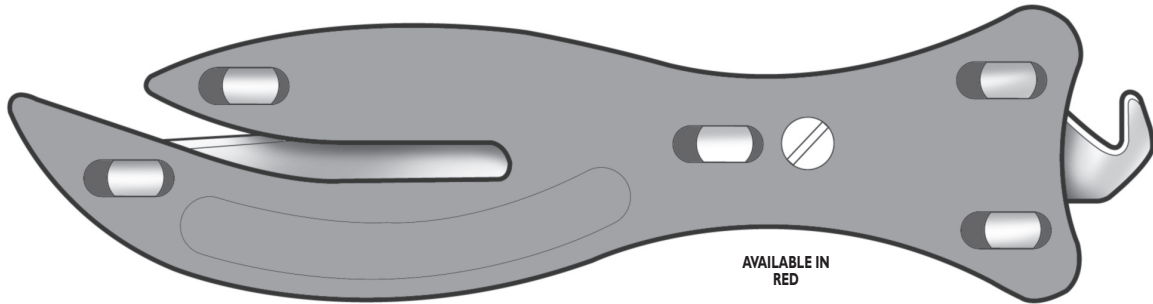

Heavy Duty Applications
Available in 2 mouth sizes:
6mm (BF360) - 9mm (BF390)

Popular Uses for the Big Fish

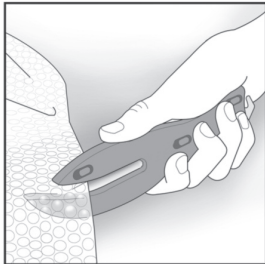

PAPER/BUBBLE WRAP

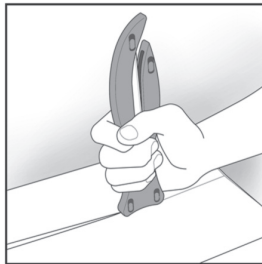

TAPE & BOXES

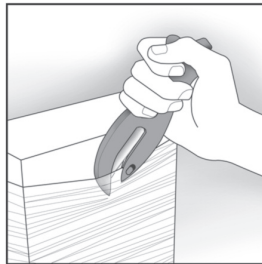

SHRINK WRAP

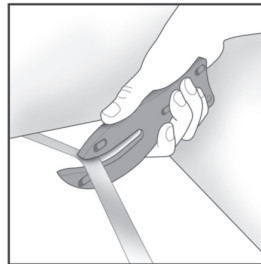

STRAPPING

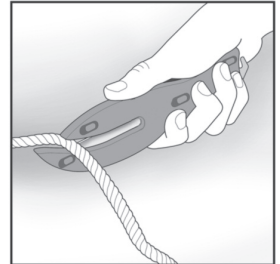

ROPE

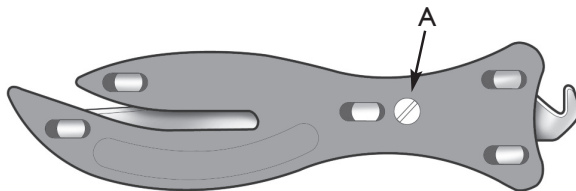

Quick and Easy Blade Change!

1. Remove screw (A) by turning counter clock wise.
2. Slide top part of knife towards the tail and lift off.
3. Change blades and re-assemble.



The Safety Knife Company

755 Old Frontenac Square • Saint Louis, MO 63131

Tel: 314•645•3900 • Fax: 314•645•0728

E-mail: sales@safetyknife.us.com

Web: www.safetyknifeus.com